

PES Filtration Apparatus



LF 30



MF 31

Features

- ▶ LF 30 : Spin-lock connection (M381450) and built-in overflow protection provide a fast, stable and safe operation.
- ▶ MF 31 : Strong magnetic seal (I5551337) allows one-handed operation and can drain the filtrate away directly without removing tubes.

Applications

General filtration, such as microbiological test, suspended solid analysis etc.

Specifications

Material	LF 30	MF 31
Funnel	PES	PES
Support base	PC	PES
Membrane support	PP	PES
Receiver flask	PC	Borosilicate glass
Syringe filter	PTFE	PTFE
Drain hose	-	Rubber (non-autoclavable)

Specifications

Funnel capacity	300 ml	300 ml
Flask capacity	1200 ml	1000 ml
Filter diameter	47 mm	47 mm
Hose barb	ID8	ID8
Drain device	-	Yes
Overflow protection	Yes	-

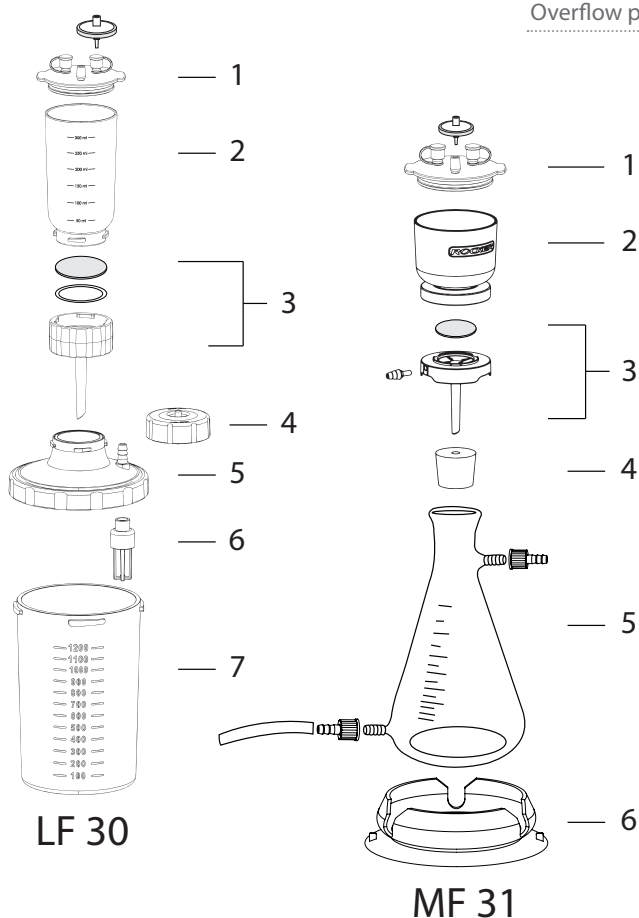

LF 30

MF 31

Ordering Information

LF 30, Filtration Set		197010-30
1	PP lid kit	197000-36
2	PES funnel, 300 ml	197000-34
3	PC support base	197000-35
4	Black PP cap	197000-40
5	PC cover	197000-32-PC
6	Overflow protection	197000-39
7	PC bottle, 1200 ml	197000-31-PC
MF 31, Filtration Set		200320-31
1	PP lid kit for magnetic funnel	200300-36
2	PES magnetic funnel, 300ml	200300-30
3	PES magnetic support base	200300-32
4	Silicone stopper (No.8)	167110-16
5	Receiver flask with drain, 1000 ml (with screwthread connector)	167300-08
6	Silicone fixing sucker	167200-45